

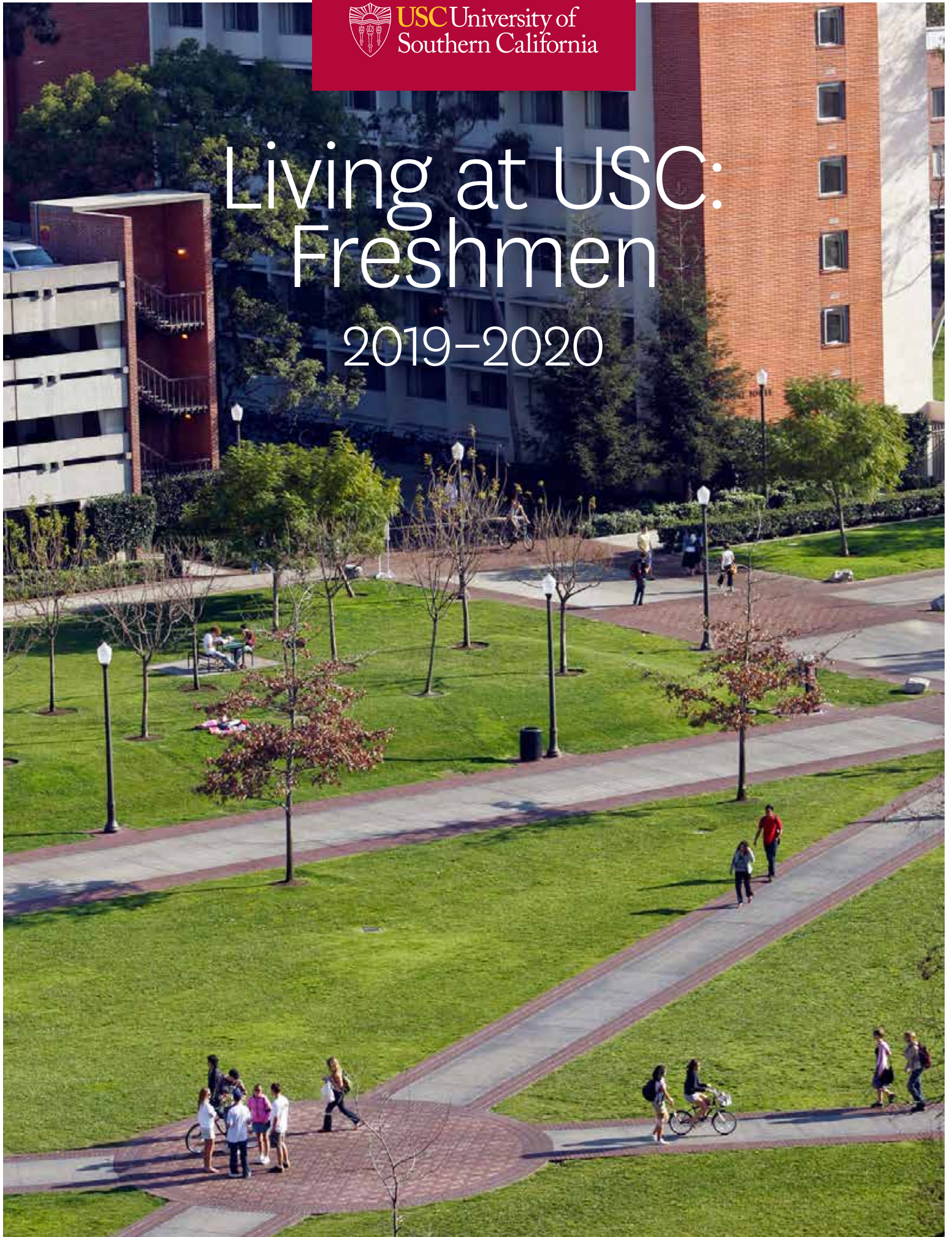

USC University of
Southern California

Living at USC: Freshmen

2019–2020





Changes. Challenges. Choices.

Your undergraduate years at USC may be your first experience living away from home, or your first time in a new city — possibly in a new country. You will be in an unfamiliar environment, keeping a different schedule and making new friends. This new lifestyle will be a change and a challenge, but it will also be memorable and exciting.

This booklet can help you with one of your biggest decisions — determining where to live. You will find descriptions of USC’s freshman housing facilities and our many special interest programs. You will also learn about meal plans, parking and how to select your roommate.

Why live in university housing? Because you will be close to your classes, USC libraries, and the student organizations and events that make campus life rewarding. Your years at USC will be enriched by your fellow residents — a mix of students from places as different as Brooklyn, Bangkok and Boise. You will make friendships that will last a lifetime.

See what we have to offer. Welcome to USC housing!

READY?

TABLE OF CONTENTS

Living Options	2
Deciding Where to Live	2
Housing for Freshmen	3
Floor Plans	4
Housing Accommodations	5
Preparation	6
Items to Bring to Campus	6
Financial Facts	7
Housing Options	8
Residential Life	23
Living with Others	23
Programming & Activities	24
Residential Services	26
USC Housing Services	26
Residential Safety	27
Meal Plans & Dining Options	28
USCard	30
USC Bookstore	30
Transportation & Parking Services	31
Housing Assignments	32
Application & Assignment	32
Housing for Spring 2020	36
Directory	37



Deciding Where to Live

With all the buildings and room accommodations USC housing offers, you need to make an informed decision. This section will help you find the housing that's right for you.



Housing Preferences

Should you live in a suite or in a residence hall? Your preference will depend on the lifestyle you enjoy. Both types of housing provide Resident Assistants, Faculty in Residence, mentors and programming and activities. Keep in mind that, no matter where you live, the quality of the experience depends largely on your participation.

The USC Housing Advantage

With university housing at USC you have...

- No commute
- Faculty involvement
- Community activities & programs
- Rent payable by university student account
- A Department of Public Safety (DPS) that operates 24 hours a day
- A computerized entry-monitoring system
- Live-in staff available 7 days a week
- Free cable TV & WiFi connections
- No extra rent to pay if your roommate leaves
- Guaranteed housing for your sophomore year
- Easy access to libraries, the Lyon Recreation Center and other campus facilities
- Free USC bus & Campus Cruiser service
- Maintenance service available 24/7 for emergency repairs
- The option to be reassigned to different housing
- Multiple workout areas with state-of-the-art equipment
- Laundry facilities



Living Options

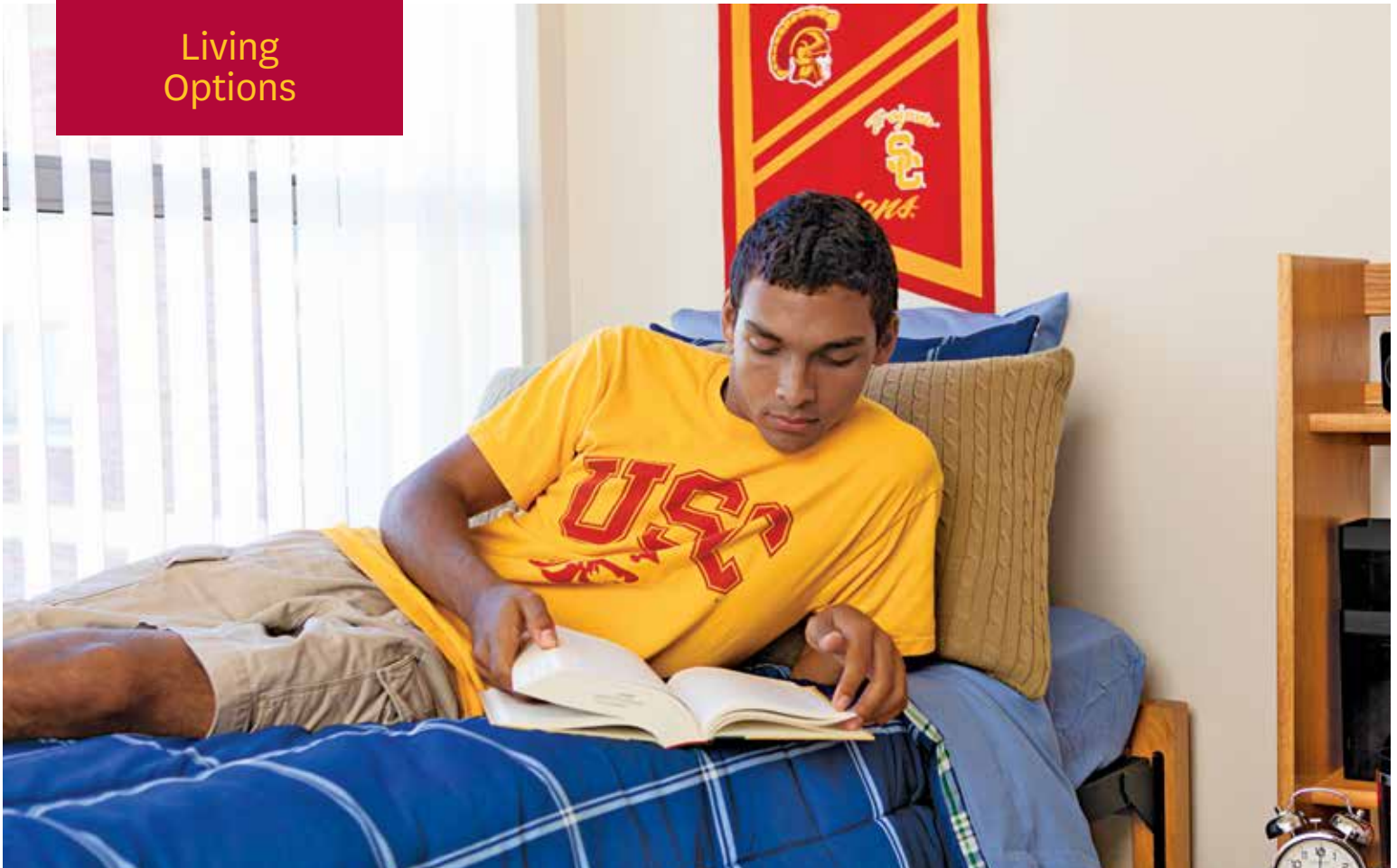

Floor Plans

USC housing offers a wide variety of floor plans. The illustrations presented here show typical configurations; however, the actual layout and dimensions will vary among buildings that share the same basic floor plans.

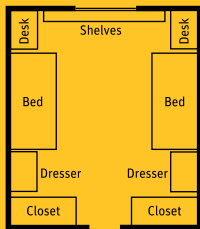

Residence Hall Double

Buildings: Birnkrant, New and North Colleges, Marks Hall, Marks Tower, Pardee Tower and Trojan Hall.

Occupancy: 2

This accommodation consists of a furnished room used for both living and sleeping.

A gender-specific community bathroom is located on the same floor. Approximate dimensions of these rooms are 12' by 15'.

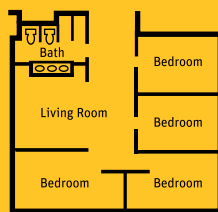

Suite

Building: Fluor Tower.

Occupancy: 8

Four double rooms open onto a common area with seating.

The large bathroom has two showers, two toilets and three sinks.

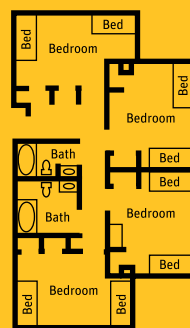

Suite

Buildings: International Residential College, Arts & Humanities Residential College.

Occupancy: 5, 6, 7 or 8

Most suites in these buildings have four double rooms for eight residents (pictured). The International Residential College has a variety of suite types, some including both single and double rooms.

All suites have two bathrooms.

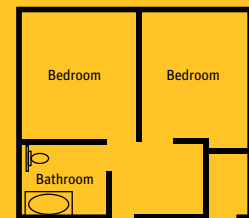

Lofted Suite

Building: McCarthy Honors

Occupancy: 4

This suite type consists of two small bedrooms, each with lofted beds (a desk and dresser are placed beneath each raised bed) and a full bathroom.

Housing Accommodations

Choosing university housing means more than just putting a roof over your head. USC strives to provide its students with a pleasant living environment that includes many special features.

General Amenities

All USC housing units provide high-speed, wireless connections and cable TV with HD and premium stations. Rent always includes electricity, gas and water costs. Laundry facilities are available in all buildings, operated by either credit or debit card —there’s no need to stock up on quarters to have clean clothes. Most buildings have recreational areas, study lounges and other common areas.

Furnishings

All university housing facilities are furnished. Every resident is provided with an extra-long twin bed (36" X 80"), desk, desk chair, three-drawer dresser and closet space. For information about ordering linens for extra-long twin beds, see page 6.

All residence hall rooms, as well as suite bedrooms, come with a microfridge (a small refrigerator-and-microwave combination unit).

Students with Disabilities or Requesting Specific Accommodations

The office for Disability Services and Programs (DSP) facilitates disabled students’ full participation at USC. Students must register with and be approved by DSP, and complete a housing application, to be eligible for special housing considerations. Please contact DSP and USC Housing as early as possible if you have such needs (including requests for single accommodations).

Housing for students with disabilities is available in several locations, accommodating different levels of access. Because of the high demand and limited supply of this housing, USC cannot guarantee assignment to a specific building or room type. DSP works closely with USC Housing to assign students with special needs to appropriate accommodations, based on availability and DSP’s recommendations.

For more information, call Disability Services and Programs at (213) 740-0776 | Video phone: (213) 814-4618.

More individualized plans and photos can be found on our website: housing.usc.edu

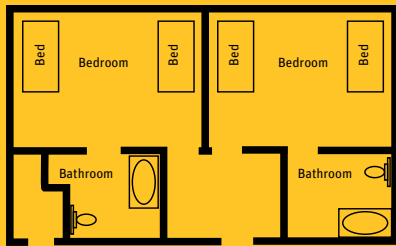

Suite

Buildings: McCarthy Honors

Occupancy: 4

Accommodating four residents, this plan has two double rooms, a small entryway with seating, and two full baths.

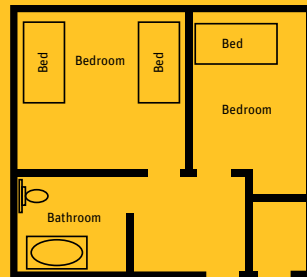

Suite

Building: McCarthy Honors

Occupancy: 3

Three residents share this suite plan consisting of a single and a double room, a small entryway and a full bath.

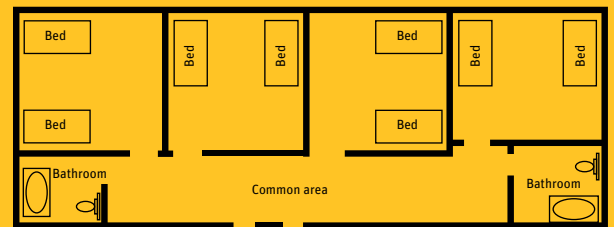

Suite

Building: McCarthy Honors

Occupancy: 8

This large suite has four double occupancy rooms, two full baths and a common area.

Furniture

All university housing suites and residence halls come with basic furniture (bed, chairs, tables, etc.) appropriate to the room type.

Every resident in USC Housing is provided with:

- One twin bed (extra long, 36" X 80")
- One desk with chair
- One three-drawer dresser

Preparation

Items to Bring to Campus

DO

- | | |
|------------------------|------------------|
| Towels | Alarm clock |
| Blankets | Toiletries |
| Bedspread or comforter | Hangers |
| Sheets | Decorations |
| Pillows & pillowcases | Fan |
| Mobile phone | Computer |
| | TV (cable ready) |



DON'T

Please leave the following at home:

Pets

Students are not permitted to have dogs, cats or other pets in USC Housing. The only exception is for fish in a 10-gallon (or smaller) tank. Residents found with a pet will be charged a substantial clean-up and re-carpeting fee, and will be documented for violating university policy.

Air Conditioners

If your housing does not have air conditioning, you may not install a unit yourself. This is considered a "physical alteration" of the room or apartment, which is prohibited by your contract for safety and security reasons. If you need an air-conditioned room, please select one of our many facilities with air conditioning when you complete your housing application.

Dish/Satellite TV Antennas

Installation of these devices is a "physical alteration" of the building and/or the room or apartment, and is not allowed for safety and security reasons. Remember: All housing facilities come with cable TV service.

RHA Linens Program

Our residence halls and apartments contain extra-long twin beds that require specific linens to fit the mattresses. The Residential Housing Association (page 24), in conjunction with On Campus Marketing, has arranged to provide you with high-quality, extra-long linens, with on-campus delivery available. This summer, you will receive a letter and order form that describes available products and special packages. Please order by the deadline to ensure you have your linens sent to USC for pick-up on Move-In Day. Proceeds fund various student leadership development programs and initiatives at USC. Please visit resed.usc.edu for more details.



Financial Facts

What costs are associated with living at USC? How does the billing system work? The information provided here will answer your questions.

Housing Fees

Application Processing Fee

A \$55 nonrefundable application processing fee must be paid at the time you submit your housing application. See "Application & Assignment," page 33.

Contract Confirmation Payment

An \$800 confirmation payment must be made online at the time you confirm your contract. See "Contracts," page 34.

Rent

Rent and meal plan costs are billed before the beginning of each semester (July and December). Charges will appear on the billing statements issued by the university Cashier's Office.

Other Charges

Residential Meal Plans

All freshmen living in residence halls and suites will have a full meal plan. Freshmen in apartments will have a partial plan. See "Meal Plans & Dining Options" on page 28.

Parking

Students choosing to purchase a parking permit will have its cost charged to their account. See "Transportation and Parking Services" on page 31.

Please consult the USC Housing, Hospitality and Transportation websites for final rates.

Billing Procedures

Each admitted student has a billing account that reflects all university-related charges and credits, including tuition, lab and general fees, and financial aid, as well as dining and housing charges. You may check on and pay your current bill by logging in to **my.usc.edu** and clicking on the Pay My Bill option. Your fall semester housing charges will appear on your August bill. Rent payments must be made to the Cashier's Office, not to USC Housing. Only application and confirmation payments are made directly to USC Housing.

If you have university billing questions, call the Cashier's Office at (213) 740-7471. Please visit financialaid.usc.edu/contactfao with any questions about financial aid or loans.



Items Included in Rent

The following are included in rent charges. Residents of USC Housing will not be billed separately for:

- Utilities (gas, electricity, water).
- Cable TV service.
- Wireless and Ethernet Internet connections.

Residential Colleges

Residential colleges provide a unique experience in which students have opportunities to meet people from all across the United States and the world. Together, they learn to live, interact and socialize, while creating memories that soon prove that this is more than just a place to sleep — it is a home away from home. Students have the opportunity to attend activities that cultivate their social, academic and cultural growth as young adults and interact with a variety of staff who are there to support them in their transition to college.

The Residential Experience

Every freshman is housed in a residential college when they arrive at USC in the fall semester. There, they form strong connections by participating in events organized by the Resident Assistants and Faculty in Residence, and become an integral member of their community through their interactions with their peers. Residential colleges also allow students to bridge the classroom experience by participating in conversations over dinner with faculty, attending presentations with guest speakers, participating in community service, and utilizing campus resources provided in their residential college lobby.

The residential college experience also bookends the undergraduate experience. New students represent their residential college at New Student Convocation and then become active participants in the year-long Residential College Cup competition. At the end of their four years at USC, students return to their residential college for a reception with their Faculty in Residence and Residential Education staff.











Building Choices

From residence halls to suites and apartments, USC housing offers a wide variety of building options. The following pages provide the details you will need to make an informed choice about where to live. You should also review the special interest communities described in this section.

Housing Icon Key

All housing facilities are non-smoking.

	Air Conditioning		Recreational Facilities
	Community Bathroom		Required Meal Plan
	Customer Service Center		Residential College
	Parking		Bus Stop
	Special Interest Community		

Rents listed and building descriptions are subject to change. Check the USC Housing website for current information.



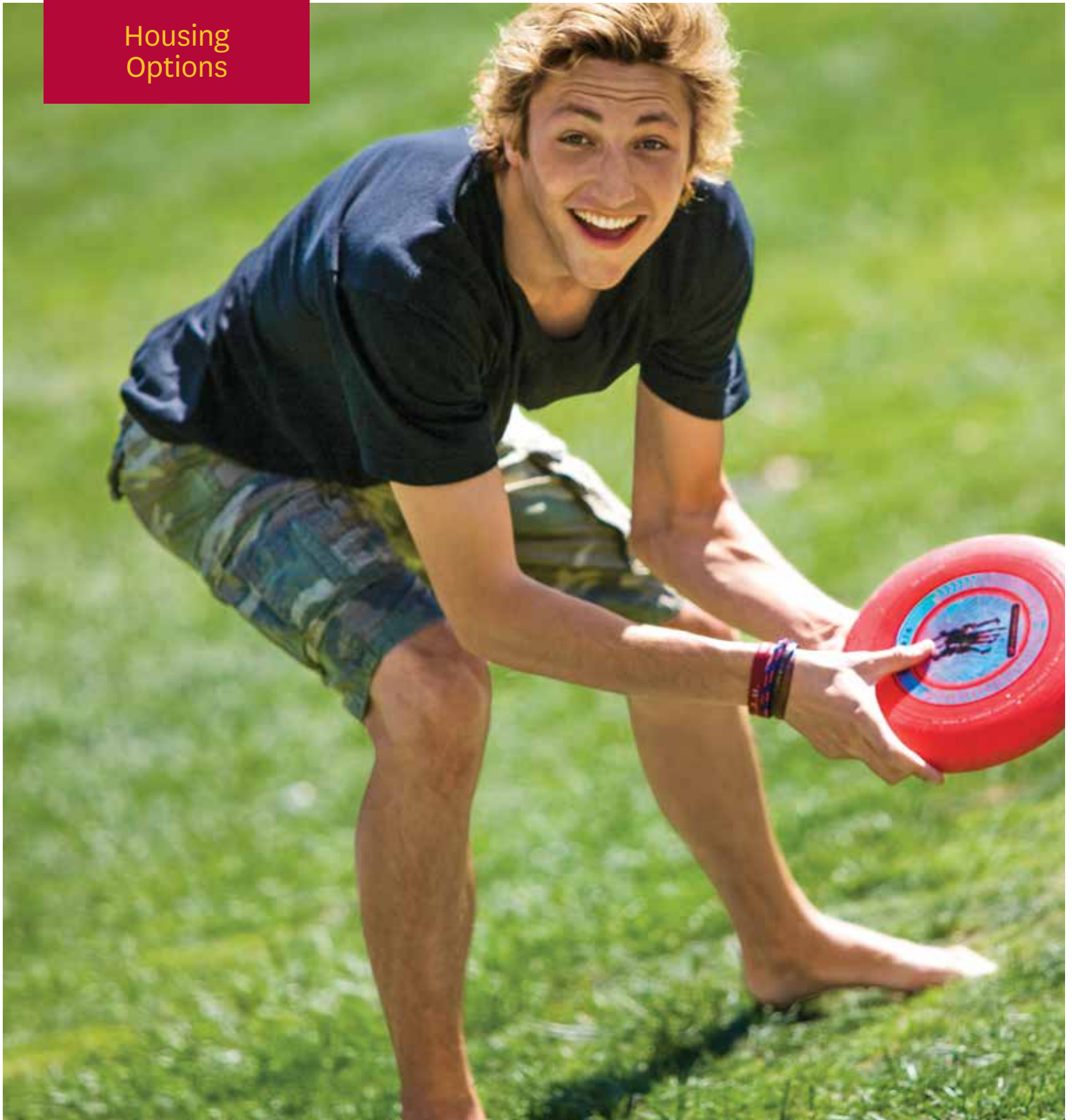

Requesting a Single

USC Housing receives many requests for single rooms. Singles comprise approximately two percent of our total housing inventory, and most are filled by returning students. Although we do our best to accommodate new applicants' preferences, it is not possible to offer singles to everyone who requests them.

Parking at University Housing

Buildings listed with the parking icon have on-site parking facilities. USC Transportation issues permits for all lots and garages. In most cases the number of spaces is limited. Applications are processed on a first-come, first-served basis; not all applicants will receive a parking space. Please see page 31 for information about obtaining a parking permit for a university housing building.



Birnkran Residential College

As the smallest residential college at USC, Birnkran Residential College enables students to be part of a tight-knit community. Commonly referred to as “8 Floors of Open Doors,” Birnkran nurtures friendships and relationships that often span the course of students’ time at USC. In 1994, Birnkran began operating as a residential college, with a full-time, live-in Faculty in Residence member working to bridge students’ experiences inside and outside the classroom.

Today, the Faculty in Residence member works alongside Residential Education staff to provide programs that introduce students to Los Angeles culture, art, food and more. Residents take great pride in living in Birnkran and often refer to it as one of their favorite USC memories.

Special Interest Communities: APIDA Leaders Community [APIDA]

The Asian, Pacific Islander, Desi American Leaders Community (APIDALC) is a program dedicated to all students who have an interest in Asian Pacific American history, culture, and social and contemporary issues. It strives to cultivate a space for active participation, leadership development, personal growth and a successful transition into college.

The APIDA Leaders Community is supported by the Office for Residential Education and the Asian Pacific American Student Services cultural center.

If you are interested in living on this floor, you must complete a supplemental application. See page 22 for details.



Birnkran Residential College (BSR)

642 West 34th Street, Los Angeles, CA 90089

				2019-2020
Spaces	Room Type	Room Code	Occupancy	Rate/Person
4	Single	SGLE	One-person	\$6,985
216	Double	DBLE	Two-person	\$4,808
39	Triple	TRPL	Three-person	\$4,935

Conveniently located next to Leavey Library and the Everybody’s Kitchen dining facility, Birnkran is an eight-story building with seven residential floors, each divided into a men’s and women’s section. Each floor has approximately 20 rooms, two large bathrooms (one for each gender) a laundry room and a recently renovated and furnished study room. The first floor includes the home of the Faculty in Residence, a music practice lounge, a study area, a multipurpose room and a lounge, and is home to the popular Starbucks at Trojan Grounds coffeehouse, which accepts meal plan Dining Dollars.

Residents have a required meal plan.



Housing Options



McCarthy Honors College

Located in the USC Village, McCarthy Honors College offers a vibrant and enhanced living learning experience for over 500 Mork Family, Stamps, Trustee and Presidential scholars in a suite-style living environment. Through faculty interaction, diverse programming, opportunities to experience Los Angeles, and an Honors College retreat, this program is designed to inspire students to reach their full potential as agents of global change.

The McCarthy Honors College experience is led by two Residential Education staff members in conjunction with the Faculty in Residence, with contributions by numerous faculty from diverse disciplines. Themed discussions are held weekly in the McCarthy multipurpose room. Guests might include USC faculty members and senior administrators, distinguished professionals in the arts and humanities, and prominent visiting scholars.

McCarthy residents move in early (Monday, August 19) to attend the Honors Retreat on Tuesday, August 20. Retreat activities focus on establishing a strong connection to the residential college and its staff, while introducing the support systems available to honors students. For more information, please visit the Residential Education website at resed.usc.edu.

Space in McCarthy Honors College is available on a first-applied basis.



McCarthy Honors College (UVF) (CIC)

3096 S. McClintock Ave, Los Angeles, CA 90089

				2019-2020
Spaces	Room Type	Room Code	Occupancy	Rate/Person
8	Single	2PSGLE	One-person	\$7,415
35	Single	3PSGLE	One-person	\$7,065
40	Single	4PSGLE	One-person	\$7,165
98	Double	3PDBLE	Two-person	\$5,430
112	Double	4PDBLE-loft	Two-person	\$3,360
16	Double	4PDBLE	Two-person	\$5,765
152	Double	4PDBLE-DB	Four-person	\$6,055
64	Double	8PDBLE	Two-person	\$5,765

The crown jewel of the dynamic USC Village, the five-story McCarthy Honors College boasts four residential floors, each with over 30 suites, multiple lounges and study rooms, and a laundry room. Two spacious landscaped courtyards, one on the ground level and the other on the first residential floor, are appointed with luxurious outdoor furniture. The ground floor houses a large lobby, classrooms, a magnificent residential dining facility, an Amazon University store, Italian Cafe, USC Credit Union and secure indoor bike parking.

This facility is nearly double the size of the previous honors housing, allowing for a greater number of qualified students to be assigned to the program. However, assignments are made on a first-applied basis according to housing configuration preferences, and housing in McCarthy is not guaranteed. Residents have a required full meal plan.





New North Residential College

Originally called North Residential College, New North Residential College was founded in 1993 and comprises EVK, College, University and Harris Halls.

New North fosters a strong community created through programs that draw upon the cultural resources of both USC and Los Angeles. Noted for its vibrant atmosphere and strong personal and academic support network, the staff and faculty sponsor activities that encourage students to learn and have fun by making close connections with each other, in the city and the world around them. Every week, students can attend a dinner hosted by New North's Faculty in Residence, who are joined by talented and accomplished guests from the university, the movie industry or from the city at large.

New North Residential College occupies a premium location on campus. You can grab a cappuccino at Starbucks at Trojan Grounds on your three-minute walk to Leavey Library, toss a Frisbee on McCarthy Quad, and appreciate the view of the neighboring reflecting pool. New North also benefits from the attached Everybody's Kitchen dining hall, which allows residents to connect with a diverse group of students from all over campus.



New North Residential College (COL-NEW) (EVK-NEW) (HRH-NRC) (URH-HRC)

635 McCarthy Way, Los Angeles, CA 90089

				2019-2020
Spaces	Room Type	Room Code	Occupancy	Rate/Person
13	Single	SGLE	One-person	\$6,320
24	Single w/sink	SGLE-WS	One-person	\$6,795
360	Double	DBLE	Two-person	\$4,808
162	Double w/sink	DBLE-WS	Two-person	\$5,365

Despite its name, New North Residential College is one of USC's oldest housing facilities. Steeped in Trojan tradition, New North combines classic residence hall architecture with modern amenities and forward-looking programs. The program comprises four residence halls: College, Elisabeth Von Kleinsmid Memorial, Harris and University.

A coeducational residential college, New North houses men and women in different areas. It is one of three residence halls offering a limited number of singles to freshmen.

A workout area equipped with treadmills, ellipticals and stationary bikes makes living a healthy lifestyle easy. Every floor has a laundry facility. The study rooms and television lounges have been recently remodeled and provide quiet reading space as well as a great place to hang out with friends. Residents have a required meal plan.





Parkside Arts & Humanities Residential College

The Parkside Arts & Humanities Residential College creates a space where students and faculty can form a strong scholarly community centered on the arts and humanities. In addition to its focus on music, writing, drama, visual arts and architecture, the Parkside Arts & Humanities Residential College connects students with the cultural offerings of the campus as well as Los Angeles. Adjacent to the residential college, the USC Fisher Museum of Art, the Roski School of Art and Design, and the School of Architecture provide convenient access to their creative communities. Living in the Arts & Humanities Residential College gives students from all academic backgrounds the opportunity to express themselves — from mounting a theatrical production, to screening their films, or reading their poetry — all in state-of-the-art facilities. Each year, residents stage a showcase of student works in the Arts in the Park program.

Members of the Faculty in Residence host weekly Parkside “Faculty Dinners” that feature stimulating guest speakers and discussions. Faculty also host floor dinners, performances, screenings, and trips around Los Angeles. Living in the college is not limited to majors in the arts and humanities. Everyone who appreciates the role of culture and the exploration of ideas is invited to apply.



Arts & Humanities Residential College (PRB)

920 West 37th Place, Los Angeles, CA 90089

				2019-2020
Spaces	Room Type	Room Code	Occupancy	Rate/Person
432	Double 8P-ST	8PDBLE	Two-person	\$5,605
6	Double 6P-ST	6PDBLE	Two-person	\$5,825

The four-story Arts & Humanities Residential College provides housing for 440 students in same-gender suites of double rooms clustered around a small common space. A wide variety of facilities are shared with the other residents of the Parkside area, including a performance space, a multipurpose room, music practice rooms, a collaborative learning center, a lounge on each floor, a laundry room, and a new arcade room, featuring a collection of classic video games. The building has a dedicated Customer Service Center. Residents of the college have a meal plan that can be used at the on-site Parkside Restaurant as well as other dining venues. Those with dietary restrictions can also find allergen- and gluten-free foods, as well as vegetarian or vegan options, at the Parkside Restaurant.







Parkside International Residential College

In the 21st century, a compassionate understanding of global issues is vital. The Parkside International Residential College serves as a campus focal point for discussing global issues, learning about international cultures and connecting with students from abroad. Living at Parkside will allow you to participate in intellectual, cultural and social exchanges with people who have a wide range of backgrounds and interests, in one of the most attractive locations on campus. Parkside International Residential College hosts a wide range of programs and events with an international theme, marking holidays and independence days from around the world. Parkside also hosts top-flight programs with experts from a wide range of fields: visiting scholars, renowned international figures, and world-class artists from stage, television and film.

Residents are encouraged to participate in local community service projects and take advantage of volunteer opportunities that draw upon the city's extensive international connections. The building's Faculty in Residence work to support group activities, events and programs that engage residents' compassion and curiosity, including field trips to see local theatre and discover Los Angeles. Residents can take advantage of a weekly dinner and dessert reception at which experts from on campus and off speak informally about their work and life experiences.

Special Interest Communities: WiSE (Women in Science & Engineering)

Residents on the WiSE floor are offered the resources and opportunities to help them excel both in and out of the classroom. Residents learn about prominent clubs and organizations on campus, attend lectures and panels by renowned science and engineering professors, and gain critical insights from older female students about attaining both academic and professional success.



Parkside International Residential College (IRC)

3771 South McClintock Avenue, Los Angeles, CA 90089

				2019-2020
Spaces	Room Type	Room Code	Occupancy	Rate/Person
36	Single-5P-ST	5PSGLE	One-person	\$6,585
14	Double 5P-ST	5PDBLE	Two-person	\$5,825
60	Double-6P-ST	6PDBLE	Two-person	\$5,825
11	Single-7P-ST	7PSGLE	One-person	\$6,345
24	Double-7P-ST	7PDBLE	Two-person	\$5,605
256	Double-8P-ST	8PDBLE	Two-person	\$5,605

Parkside International Residential College is located in the southwest corner of campus. The four-story building provides housing for 400 students in a variety of five-, six-, seven- and eight-person suites, mixing single and double rooms. Residents enjoy privacy and independence, as well as the benefits of a residential college. Although IRC has "international" in its name, the college is made up of students with varying backgrounds from the U.S. and around the world.

The complex shares facilities with residents of the Parkside area, including a collaborative learning center for group study, formal and informal meeting and seminar spaces, music rooms, lounges, a recreation room with exercise equipment, a laundry facility and a Customer Service Center. The central dining hall features international gourmet cuisine and accommodates special dietary needs, such as gluten-free and vegan.





South Residential College

South Residential College comprises four traditional residence halls: Marks Hall, Marks Tower, Pardee Tower and Trojan Hall. This large complex for freshmen is conveniently located near the Doheny and Leavy Libraries, Tutor Campus Center, important campus service departments, several popular classroom buildings and McCarthy Quad, an ideal place to relax and enjoy the great Los Angeles weather.

A signature of this residential college is its close-knit community — many describe South as being a true “family.” South Residential College is supported by an engaging team of faculty and staff who endeavor to create a vibrant community where emphasis is placed

on the transition to college and exploring USC’s First-Year Experience programs. Programming provided by faculty and staff emphasizes personal growth and determining one’s best pathway for leadership as a USC student and future graduate.

The Faculty in Residence take the lead in creating an environment conducive to student learning and social engagement. Each building has one Faculty in Residence. Residents are encouraged to attend Faculty Dinners and participate in faculty-student interaction outside the classroom. Students in South Residential College have always benefited from the sense of belonging created within these floor communities, the smallest at USC.





South Residential College



Marks Hall (DXM)

631 Childs Way, Los Angeles, CA 90089

				2019-2020
Spaces	Room Type	Room Code	Occupancy	Rate/Person
2	Single	SGLE	One-person	\$6,185
80	Double	DBLE	Two-person	\$4,808

Built in the classic style of college residence halls, three-story Marks Hall is located next to the university's historic Alumni House. Its small community provides a perfect environment for residents to get to know one another. A pleasant lawn and garden plaza are right outside the front door.

The hall's first floor has two lounges: one set up for group meetings, the other more suited to individual and small-group study. The second and third floors are living areas. The basement has a laundry room and a recently upgraded exercise area, with a weight machine, treadmills and ellipticals. Residents have a required meal plan.



Marks Tower (DMT)

612 Hellman Way, Los Angeles, CA 90089

				2019-2020
Spaces	Room Type	Room Code	Occupancy	Rate/Person
188	Double	DBLE	Two-person	\$4,808

At eight stories tall, Marks Tower offers all the features of a traditional residence hall— and gorgeous views from many of the rooms. The primarily freshman population lives, eats and studies together while participating in the campus and residential activities so important to a student's first year at college. This coed facility has seven single-gender residential floors, each with 14 double rooms. The common area on the ground floor features a spacious remodeled lounge with comfortable living room seating around a large TV. Marks Tower is conveniently located next to libraries, classrooms and dining facilities. Residents are welcome to use the workout room in adjoining Marks Hall. There is a required meal plan.





Pardee Tower (PTD)

614 Hellman Way, Los Angeles, CA 90089

				2019-2020
Spaces	Room Type	Room Code	Occupancy	Rate/Person
280	Double	DBLE	Two-person	\$4,808

Close to Doheny Library and McCarthy Quad, this eight-floor coed residence hall alternates single-gender floors. Each floor has 18 double rooms, a common bathroom and a laundry facility. The air-conditioned lobby features a flat-screen TV area and comfortable seating where residents can relax and catch the latest game or news. The building has study lounges on most floors, as well as a music practice room. The large, newly renovated second-floor lounge and programming space provides several large TVs, tables and comfortable seating — a great place to watch Trojan football games. Residents can also use the exercise equipment in the Marks Hall basement. Pardee Tower is a great place to make friends easily while maintaining a positive lifestyle balance of work, rest and play. Residents have a meal plan that can be used at any residential dining facility, as well as other campus eateries.



Trojan Hall (TRO)

615 Childs Way, Los Angeles, CA 90089

				2019-2020
Spaces	Room Type	Room Code	Occupancy	Rate/Person
208	Double	DBLE	Two-person	\$4,808

The size and layout of three-story Trojan Hall helps residents socialize and get to know each other, while building a strong community within the complex. It is conveniently located across the street from Popovich Café and the eateries of Fertitta Hall. A small gym facility is located next door in the basement of Marks Hall. Trojan Hall has double rooms on three floors, with a comfortable air-conditioned lobby on the first floor and a laundry facility in the basement. Residents have a required meal plan.





West Residential College

Composed of Fluor Tower and Webb Tower (a building for upperclassmen), West Residential College is conveniently located near the Engemann Student Health Center, the Lyon Recreation Center, and the Uytengsu Swim Stadium. As such, West Residential College has begun to develop various wellness-based initiatives. Faculty in Residence focus on different aspects of holistic wellness and hope to create all-encompassing programming around these initiatives. West Residential College is supported by a dynamic team of faculty and staff who endeavor to create a vibrant community

Special Interest Communities:

El Sol y La Luna Latino Floor [LATF]

For over 45 years this special interest residential program has offered first-year Latinx students a positive, supportive community that eases the transition into USC life and empowers them to become prominent campus leaders. Through extensive community service, cultural, academic and social activities, members of the floor discover their Trojan Family, while finding academic and personal success.

El Sol y La Luna is supported by the Office for Residential Education and El Centro Chicano. If you are interested in living on this floor, you must complete a supplemental application. See page 22 for details.

Somerville Place [SMRV]

Named after John and Vada Somerville, the first African American graduates of the Ostrow School of Dentistry, Somerville Place focuses on uplifting and exploring identities within African-American culture and the larger global diaspora. By promoting intellectual development, providing opportunities for leadership and connecting to a legacy of scholars, Somerville Place has aided in the successful transition of black students into the USC community for over 20 years.

Somerville Place is supported by the Office for Residential Education and the Center for Black Cultural and Student Affairs. If you are interested in living on this floor, you must complete a supplemental application. See page 22 for details.



Fluor Tower (FLT)

1027 West 34th Street, Los Angeles, CA 90089

				2019-2020
Spaces	Room Type	Room Code	Occupancy	Rate/Person
7	Single	SGLE	One-person	\$7,030
312	Double-8P-ST	8PDBLE	Two-person	\$5,605

Built in 1971, Fluor Tower is an 11-story, suite-style community of predominately freshman students. Fluor's attractive lobby features a television area, community kitchen and a Customer Service Center. Each residential floor has four suites (typically, two for men and two for women) housing eight students, and a lounge for group study, special programs and community events. Suites house eight students in four double rooms and have a common living area, air conditioning and an extra-large bathroom with double facilities. Located next door is King Hall, featuring a computer lab and a large, mixed-use room for study and educational programs. The Lyon Recreation Center is just steps away. All residents have a required meal plan.



Apartment Options for Freshmen

For those freshmen who would prefer apartment-style living, a limited number of units will be available in two of our buildings for upperclassmen.



Cale and Irani Residential College (CIC)

929 West Jefferson Boulevard, Los Angeles 90089

				2019-2020
Spaces	Room Type	Room Code	Occupancy	Rate/Person
44	Two-bedroom	2B4P-LOFT	Four-person	\$3,300
48	Two-bedroom	2B4P	Four-person	\$5,430

Located in the USC Village complex, the stylish five-story Cale and Irani Residential College features a 30,000 square-foot, state-of-the-art fitness center, a FedEx Office retail location, numerous retail dining establishments, a large secure indoor bike parking room and a Customer Service Center. The second floor has two large courtyards, offering great places to gather with friends or to study day or night. Four luxurious lounges with floor-to-ceiling glass walls overlook these courtyards from the fourth and fifth floors, and are open to all residents.

All apartments are fully furnished and have central air-conditioning. The small, two-bedroom loft-style type does not have a living room. In place of full kitchens, their kitchenettes include a sink, oven and four-burner range, and each bedroom has a small microwave oven and mini-fridge. Freshman residents will have a mandatory full meal plan that can be used at the USC Village Dining Hall, as well as other USC Hospitality outlets.

The Cale Residential College takes an interdisciplinary approach to international issues with the goal of creating global citizens. The Irani Residential College focuses on performance science — the confluence of mind, body and business. Residents will learn ways to maximize performance, both individually and within an organization or community.



Cardinal Gardens (CAR)

3131 McClintock Avenue, Los Angeles 90007

				2019-2020
Spaces	Room Type	Room Code	Occupancy	Rate/Person
12	One-bedroom	1B2P	Two-person	\$5,650
48	Two-bedroom	2B4P	Four-person	\$4,965

This townhouse-style apartment complex consists of nine individual buildings. The fully furnished and recently renovated one- and two-bedroom apartments have full kitchens, spacious air-conditioned living rooms with laminate floors and modern furniture. Located just across Jefferson Boulevard from campus, Cardinal Gardens is convenient to the Lyon Recreation Center, the USC Village Dining Hall and the other amenities of the USC Village. All residents have a required meal plan. Recreation options include watching the 70-inch TV or playing pool inside the CSC lounge, playing basketball on the half-court outside, or relaxing on the landscaped patio with resort-style seating, dining tables, two barbecues, a fireplace and a water feature. Ample parking is available in the surface-level lot within the complex's gated and walled perimeter.



Freshmen in Undergraduate Apartments

For those incoming students who feel their housing needs would be better met by living in an apartment than a suite or residence hall, a limited number of apartments will be available for freshmen in two buildings for upperclassmen. Unlike other freshman housing facilities, apartments do not close for the winter break and may be continuously occupied between the fall and spring semesters.

Both facilities have live-in Residential Education staff and onsite Customer Service Centers and are located adjacent to campus. Freshman residents will be assigned a meal plan specific to their housing assignment. More information about these buildings can be obtained by visiting our website.

Most of the residents of these facilities will be returning and transferring undergraduates. Freshmen will be limited to the number of spaces and room types indicated. Requests for apartments may exceed the number of spaces allotted.

Special Interest Housing

Our special interest housing enhances your university experience, bringing together students and faculty to share in cultural and academic programs. USC special interest communities attract students who want to make the most of their college years, yet each community offers something different. Some bring together students with similar career or academic interests. Others attract people interested in a particular culture or lifestyle. Some communities are small, while others are quite large.



How to Apply for Special Interest Communities

If one of these special interest communities seems right for you, be sure to select the program on your housing application. Many special interest communities are available to incoming freshmen only. Check first to confirm you are eligible for your choices. (For example, students must meet certain academic qualifications to live in McCarthy Honors College.) When applying online for housing, be sure to first specify the residence hall, suite or apartment, and then specify the special interest community located within it. Some programs fill quickly, so apply early. The following special interest communities require supplemental applications: APIDA Floor, Religion and Spirituality, Latino Floor, Rainbow Floor, and Somerville Place. Supplemental applications will be available as part of the online housing application process. (See page 33.)

Special Interest Communities in Predominantly Upperclassman Housing

CENTURY APARTMENTS

Rainbow Floor

The Rainbow Floor provides lesbian, gay, bisexual, transgender and queer (LGBTQ) students, along with their straight allies, a safe and affirming living environment. This floor is one of a few themed student-housing programs in the United States designed specifically for the LGBTQ community and its allies. Residents are members of Rainbow Scholars, a student organization that promotes the floor through community service, social events and faculty discussions. The Rainbow Floor collaborates with academic departments, other campus residential communities, the LGBT Resource Center and the Office for Residential Education to sponsor campus and community events. The Rainbow Floor's Overnight Experience gives prospective students the opportunity to visit campus, attend classes, participate in LGBTQ events and stay with a student host. All apartments on the Rainbow Floor are gender-inclusive. All students who identify as LGBTQ or as an ally are encouraged to apply. The Rainbow Floor is supported by the Office for Residential Education and the LGBT Resource Center. If you are interested in living on this floor, you must complete a supplemental application. See "How to Apply for Special Interest Communities" on this page for details.

PARKSIDE APARTMENTS

Religion and Spirituality Floor

As one of the most religiously diverse campuses in the U.S., the University of Southern California reflects the diversity of Los Angeles and the nation. The Religion & Spirituality Floor at Parkside Apartments embraces this remarkable diversity as a means for students to grow both academically and spiritually. Students who represent the diversity of religious traditions and ethical worldviews are invited to live in a community of interfaith engagement and spiritual exploration. Residents will have an opportunity to collaborate with the Interfaith Council, and to SoulJourn across Los Angeles, visiting the various religious sites near campus: mosques, Hindu temples, Sikh gurdwaras, synagogues and more.

Religion and Spirituality is supported by the Office for Residential Education and the Office of Religious Life. If you are interested in living on this floor, you must complete a supplemental application. See "How to Apply for Special Interest Communities" on this page for details.

Life in USC Housing

Living in university housing will enrich your freshman year. Joining a community of fellow residents, faculty and staff members, and engaging in activities and programs, will broaden your interests and support your studies.

Living with Others

Coeducational Living

Our residence halls are primarily coeducational, with men and women assigned to different wings or floors with separate bathroom facilities. Buildings with apartments or suites are coed, with each unit designated for a single gender. Gender-neutral housing is available for freshmen. Contact the Division of Student Affairs regarding application requirements and space availability.

The Roommate Experience

One of the most anticipated events for college students is meeting their roommates. Living with new people is an opportunity to learn from others and share experiences.

Students have different expectations regarding roommate relationships. Some people simply want a person who is easy to live with, while others are looking for a new best friend. You don't have to be best friends to be good roommates. In fact, it can be easier to live with someone when you spend most of your time with other people. What is important is learning to adjust to new people.

Roommate Requests

If you have a specific roommate in mind, the two of you must request each other and list identical housing preferences, including special interest programs, when completing your housing applications. You can search for your requested roommate on the Search by Details page of the housing portal, and then add them to your application.

Online Roommate Matching

Most new students do not have a specific roommate in mind when they apply. Our online roommate-matching process will help you search for and contact potential roommates. To use this feature, follow the instructions on page 33 for registering with USC Housing. Profile questions will ask you about your study and sleeping habits, musical tastes and what you like to do in your spare time. Your answers will be used by our search tool to match you with students who have similar habits and interests.

You will be prompted to create a screen name, enabling you to participate anonymously in the matching process. USC does not



use your screen name for any other purpose. (Note: Screen names deemed inappropriate or offensive will be deleted and information about their use forwarded to Student Judicial Affairs as necessary.) Once you apply, you can use our website to search for roommates. You will be provided with potential roommates' screen names and be able to review their answers to the Profile questions. Using screen names, you can then contact anyone you think may be a good match for you. If you find someone compatible, you will have to log in to our system to confirm the roommate request. USC Housing will make every effort to honor your request but cannot guarantee that it will be fulfilled. Once you have been assigned, you may not search for roommates.

Roommate Assignments

If, like most freshmen, you do not have a specific request, you will be assigned a roommate based on gender, building assignment and information in the Your Profile section of your housing application. Unlike requested roommates, these matches are subject to change as students are reassigned.

Roommate Information

For applicants participating in roommate-matching, updated roommate information will be available on our website as assignments are completed. You communicate with your roommate or roommates by screen name, and share contact information as you see fit.

Programming & Activities

The office for Residential Education provides many activities and events that are great ways to get to know the people in your building and to make friends. USC's Residential Education staff designs programs that support your out-of-class learning experiences, create a sense of community on your floor and foster pride in your Residential College. Your Resident Assistant (RA) will keep you informed about upcoming events. The Resident Assistants and Faculty in Residence work collaboratively to explore Los Angeles, a city that offers world-class museums, recreational sports, beaches, music and theatre performances, and great restaurants and vibrant ethnic neighborhoods. Additionally, every Friday and Saturday night, look for the Cardinal & Gold series that offers late-night programs like new-release movie screenings, trips to Santa Monica, as well as trips to support local sports teams. For up-to-date information, talk with your RA, look for campus posters, follow USC Residential Education on Facebook and Instagram, and be sure to download the Residential Experience app from the Apple iTunes or Google Play stores.

Residential Housing Association (RHA)

The Residential Housing Association serves all students who live in university housing by providing them with ways to contribute to and enhance their residential experience at the University of Southern California. RHA acts as a unified voice to build community, empower residents, and create opportunities for leadership development. RHA also strives to act as a resource by promoting and practicing self-governance, while representing the residential community on both regional and national levels. In addition, RHA is the governing board for each Community Council (CC), a group of elected leaders in each of the residential colleges. For more information stop by Student Union 200.

Smoke-Free Environment Policy

All University Park (on-campus), North University Park (off-campus) and Health Sciences Campus housing facilities are smoke-free environments. Smoking is prohibited in all indoor and outdoor facilities on university owned properties without exception.





Residential Education Staff

The Residential Education staff fosters the holistic development of members within the USC residential community. They are committed to providing purposefully inclusive communities that create opportunities for personal and academic success in collaboration with members of the Trojan Family. The Residential College Coordinators (RCC) are live-in professionals who supervise Graduate RCCs and the Resident Assistants (RA) and manage a Residential College. Assistant Directors are live-in professionals who supervise the RCCs and oversee three Residential Colleges. The RCCs and ADs in Residential Education all have master's degrees in higher education, student affairs administration, educational counseling or a similar area. All housing facilities have a staff of Resident Assistants (RAs), typically with one RA assigned to each floor or wing. RAs support your academic and career goals, provide programming to help you connect with other students, provide support, and offer guidance about university policies. RAs are students, too, so they know firsthand what you are going through. They are trained to assist in a variety of situations and can be especially helpful in mediating roommate issues. RAs are supervised by either RCCs or Graduate RCCs with several years of experience in on-campus living.

Members of the Residential Education staff are on call at all times and available to assist residents and offer support to students and family members, especially in emergency situations.

Residential Education

Phone: (213) 740-2080

Website: resed.usc.edu



Living on Campus

Selecting your housing is just the beginning. You also need to know how to get your USC ID card, how to apply for a parking space and how to choose a meal plan. In this section you will find the information you need about the range of services provided for USC residents.



USC Housing Services

Move-in and move-out, reassignment to a new building, help with maintenance problems — these are just some of the many residential services offered by USC Housing.

The Housing Services Office

Housing Services' full-time, professional staff handles housing assignments and billing, and is available by phone or email to answer your questions.

Customer Service Centers (CSCs)

Six Customer Service Centers are conveniently located in our freshman housing facilities, each serving a specific community of buildings. You won't have to travel very far to take care of business. Our trained staff of full-time Customer Service Representatives and student support workers is available on-site to take care of move-in and move-out, early arrival requests, mail and package delivery, and maintenance issues. See the inside back cover for a list of CSC locations and telephone and fax numbers.

Housing Maintenance Services

The upkeep and cleanliness of university housing facilities are important for residents' comfort, health and safety. USC Housing has custodial staff responsible for maintaining the public areas in each building, and a maintenance office to handle repairs. You can request a repair in person, by phone or online. Assistance with emergency maintenance needs is available 24 hours a day, seven days a week.

ResNet Internet Access

USC Housing provides high-speed wireless connections throughout its facilities. Residents may register with ResNet after moving in.

Cable TV Service

All USC housing facilities provide cable television service with an expansive lineup of channels, including Showtime and HBO, with a number in HD. There is no additional monthly charge for cable TV. Students who wish to take advantage of this service should bring a digital-ready television with them when they move in.

Telephone Service

Due to the widespread use of mobile phones by college students, USC has eliminated landlines from university housing. (Residents may request the installation of a landline at an additional cost.) Public phones, where students can dial campus numbers and 911, are located in all university housing facilities.



USC Housing Services Office

McCarthy Way Parking Structure (PSX)
Between New North Residential College and Pardee Tower
620 McCarthy Way | Los Angeles, CA 90089-1332

Phone: (800) 872-4632 or (213) 740-2546

Fax: (213) 740-8488 **Email:** housing@usc.edu



Residential Safety

Department of Public Safety (DPS)

As the central coordinating office for USC's security programs, the primary goal of DPS is to ensure a safe environment in which the social and academic endeavors of the university can be realized.

DPS operates 24 hours a day, seven days a week. You should call DPS to report any emergency, including serious accidents, crimes, suspicious circumstances, fires and safety hazards.

The DPS office deploys security personnel on and around campus, and USC safety officers have clearly defined responsibilities. They patrol on and off campus in cars, on bicycles and on foot; conduct preliminary investigations of reported crimes; and file Los Angeles Police Department crime reports. Community Service Officers patrol all university-owned residential facilities and monitor the Access Network 24 hours a day.

Nearly 300 emergency telephones, identified by a blue light on top of the booth, are strategically located around campus, in many buildings and on each level of every parking structure. These phones provide a direct line to the DPS office and should be used only in emergencies.

All students are also encouraged to download the Trojan Mobile Safety App (LiveSafe), which provides immediate access to DPS and a "Safewalk" feature for any time you may have to walk somewhere alone. For more information, please visit www.usc.edu/mobilesafety.

Residential Verification Program

As part of our effort to make USC housing safer for our students, we have 24/7 security in every on-campus housing facility, as well as biometric verification stations and security surveillance cameras. Residents will be required to use their USC ID cards to enter the facility and complete a biometric scan to verify that they live there. Prior to picking up their keys, all incoming freshmen will need to have their biometrics registered at their Customer Service Center. All resident information is stored locally and is not accessible to the general public or via the Internet.

Department of Public Safety

Downey Way Parking Structure (PSA)

Emergency Only: (213) 740-4321

(or use a campus emergency phone)

General Information (DPS activities, policies or available services): (213) 740-6000



Meal Plans & Dining Options

One of the most important parts of your residential experience at USC will be what you choose to eat. USC Hospitality is delighted to offer you award-winning options in alignment with our 'Food Philosophy' and goal to provide craveable, socially responsible cuisine for the Trojan Family. From traditional dining halls to a mix of restaurants, cafés and convenience stores, our program is designed to meet the unique needs and tastes of our student body.

Meal plans are assigned based on housing location and class standing. Students whose residential location does not require a meal plan may choose to participate in any plan on an optional basis. All freshmen living in university housing will be assigned a meal plan specific to their residence when they confirm a USC Housing contract. Residents may elect to change or upgrade to any meal plan available for their assigned hall or apartment. All plan changes must be submitted by August 30, 2019, for fall 2019 and by January 19, 2020, for spring 2020.

We offer a variety of meal plans that can be tailored to your specific needs. In the "Full Meal Plan" category, our Cardinal and Gold Meal Plans both offer unlimited meal swipes in all three residential dining halls (Everybody's Kitchen, Parkside and the USC Village Dining Hall), while the Trojan Meal Plan offers a pre-established bank of dining dollars that can be used at all USC Hospitality venues throughout the University Park and Health Sciences campuses. An upgrade to the Gold Meal Plan provides valuable Dining Dollars that can be used at USC Hospitality venues throughout campus. For a full list and description of our meal plan options, please visit hospitality.usc.edu.

Prices for 2019-2020 meal plans have not been finalized as of the publication of this brochure. Updated information and pricing for fall 2019 meal plans will be available on the Hospitality website in spring 2019.

Required Meal Plans

Students assigned to any of the residential colleges (both residence hall and suite-style) described in this book are required to have a full meal plan.

Freshmen living in USC-owned, off-campus apartment buildings are required to have at least a partial meal plan, but may upgrade to a full plan. Those assigned to on-campus apartments will be required to purchase full meal plans.

Other Dietary Options

Kosher

Kosher meals are available at Seeds Marketplace, where all forms of payment, including Dining Dollars, are accepted.

Vegetarian & Vegan

Everybody's Kitchen, Parkside, USC Village Dining Hall and campus retail venues offer vegetarian and vegan entrées, side dishes and salads.

Food Allergies and Other Special Dietary Needs

We recommend that students with special dietary preferences or medically related needs contact the Hospitality dietitian at lpine@usc.edu prior to accepting a housing assignment. This will enable you to determine the location and meal plan best suited to your personal dietary needs. For additional information regarding meal plans and other services provided, contact USC Hospitality.

USC Hospitality

Phone: (213) 740-6285 **Website:** hospitality.usc.edu

Visit the USCard website at mycard.usc.edu to change or inquire about the status of your meal plan.

Residential Dining Halls

At USC, we are committed to providing a dining program with a wide range of options and facilities to ensure you have a positive dining experience every time you visit.

Accepted Meal Plans: All dining facilities listed here accept meal plans (within plan restrictions), as well as Dining Dollars and Discretionary transactions.

Everybody's Kitchen (Open seven days a week)

Featuring a buffet-style format as well as exhibition-style cooking, this newly remodeled restaurant offers freshly prepared entrées, seasonal vegetables, vegetarian options, an extensive salad bar, pizza and a make-your-own-sandwich bar. Our restaurant staff fosters community interaction by planning and preparing special theme dinners throughout the semester.

Parkside Restaurant (Open seven days a week, late nights Monday through Friday)

Parkside's menu remains consistent with its international theme but focuses specifically on Asian, Latin and Mediterranean cuisines. The exhibition-style format allows guests to observe the culinary staff in action. We are proud to feature an Allergy Awareness Zone designed for diners who are sensitive to the top eight allergens, as well as sesame and gluten. (Registration is required for access.)

USC Village Dining Hall (Open seven days a week)

The USC Village Dining Hall features an exhibition-style format to showcase the chef-driven menus, deeply rooted in four of the experience principles of our Food Philosophy, in multiple stations. This dining hall is our first to have a station 100 percent dedicated to plant-based cuisine.

Cafés & Quick-Serve Venues

USC Hospitality operates a variety of cafés and eateries conveniently located around campus. You are never far from a cup of coffee, a sit-down meal or a grab-and-go lunch between classes. In addition to healthy, fresh menu items, we offer attractive, inviting settings ideal for meeting friends or studying. Hot and cold selections are available for breakfast, lunch and dinner. Our cafés serve familiar brands such as Starbucks, Peet's, Coffee Bean & Tea Leaf and Illy; and our skillful baristas will craft your coffee, tea or ice-blended beverage to perfection on every visit. Located near Tommy Trojan, the Ronald Tutor Campus Center has become the true dining and social gathering spot for all Trojans. The impressive complex features the largest number of dining outlets at USC, including Seeds Marketplace, California Pizza Kitchen, Panda Express, The Habit, Coffee Bean & Tea Leaf, Lemonade, and Verde. Campus Center venues include plasma screens, a contemporary sound system, ATMs and WiFi.

USCard

As your student ID card, your USCard is also a multipurpose passport to services and activities on the USC campus. It enables you to gain entry to your USC housing, track your meal plan usage and conveniently pay for campus purchases.

The USCard office recommends that you submit a JPEG photo image via their website, and your card will be ready for pick-up when you arrive on campus. Refer to the "Getting Your ID" instructions on the USCard website for more information. Alternatively, you can visit the USCard office in the McCarthy Way Parking Structure (PSX) on the main campus to have your picture taken and your card made.

Identification

By identifying you as a currently enrolled student, your USCard entitles you to many campus privileges. It enables you to gain access to USC libraries, computer centers, and the Lyon Recreation Center and other recreational facilities. It is also your ticket to USC athletic events, including football games, and can be used for discounts for on-campus cultural events. You should carry your USCard with you at all times.

Purchases

You can arrange to use your USCard as a debit card to buy a variety of goods and services on campus, including books and merchandise from the USC Bookstore, daily parking permits at most university

parking structures and lots, entertainment, amusement park and sporting event tickets from the USC Ticket Office, and items from convenience stores on campus. In addition, the card can be used in many university vending and copy machines.

Meal Plans

If you are enrolled in a meal plan, your USCard will be electronically programmed with your plan's features. Simply present your card to the cashier to pay for your meal.

Access Network

The Access Control System Network is an electronic entry-monitoring system that operates in all USC Housing facilities. The Access Network's closed-circuit television and alarm systems help ensure residents' safety. If you are a resident of a university-owned housing facility, your USCard is programmed to function as an electronic "key," giving you access to your building or apartment complex and parking facilities.

USCard Services

McCarthy Way Parking Structure (PSX)
620 McCarthy Way, Room 200 | Los Angeles, CA 90089

Phone: (213) 740-8709 **Website:** mycard.usc.edu
(Visit the USCard website to sign up for various meal plan services or to add Discretionary Points to your account.)

The USC Bookstore

The Official Store of USC, the USC Bookstore proudly serves the academic and spirit needs of USC students, faculty, staff, alumni and fans.

In addition to textbooks and course materials, the USC Bookstore offers a wide selection of other products, including school and office supplies, technology, clothing, gifts and exclusive Trojan apparel and souvenirs.

Our online store at www.uscbookstore.com offers USC gifts and apparel available in the campus store, as well as technology products.

Remember: The USC Bookstores are the only places that you can use your USCard to purchase course materials and technology products.

The USC Bookstore

University Park Campus (213) 740-0066 **Customer Service** (800) 447-8620
Website: www.uscbookstore.com



Transportation & Parking Services

USC Transportation Services is the key to your university parking and transportation needs.

Parking Permits

USC Transportation offers parking convenient to all University Park Campus housing facilities. A permit is required to park in any USC structure or lot. Spaces are limited, and they sell out every year, so apply for your permit early.

Permits are issued by lottery for the entire academic year (fall and spring semesters). Your student fee bill will be charged once in the fall and again in the spring. If you need to cancel your permit for any reason, it must be returned to USC Transportation to avoid further charges. To purchase a permit, please visit the Transportation website at www.usc.edu/parking and create an online Parking Account. During the Parking Lottery Registration Period, log in to your account and click on Add or Edit Parking Waitlists to add yourself to waitlists for up to eight different lots, in descending order of preference. Registration periods are May 1 through June 30 for fall permits, and November 1 through December 7 for spring permits. You will be notified by email after the registration period closes.

Bus Service

University-owned buses operate seven days a week, from early in the morning until late in the evening, providing service to nearby apartments. Schedules are available online and in person from USC Transportation. Students, staff, faculty and university guests may use the buses free of charge.

Campus Cruiser/Lyft

The student-run Campus Cruiser/Lyft program provides a supplementary service to our buses and a safe ride home for students and staff during evening hours. This car service offers rides to locations within an approximate one-mile radius of the center of campus. Lyft provides additional free service when wait times exceed 15 minutes.



USC Transportation Office

McCarthy Way Parking Structure (PSX) | University Park Campus.
Phone: (213) 740-3575
 For the most up-to-date parking rates, bus schedules and more information, visit www.usc.edu/parking.

Parking Locations & Rates

Parking is available on the University Park Campus, at all university-owned apartments in the North University Park area and at the Grand Avenue Structure. A permit is required to park in any USC structure or lot.

Spaces are limited.

Please note: Information regarding parking permits and rates is accurate at the time of publication. Permits, conditions and pricing are subject to post-publication changes.

Permit	Location	Price
University Park Campus	On-campus parking structures	\$499.50 per semester
North University Park	On-site lots at housing facilities north of Jefferson Blvd.	\$337.50 per semester
Grand Avenue Structure	East of University Park Campus. Bus service is available to and from campus every 15 minutes, Monday–Friday, 6:30 a.m.–11:00 p.m.	\$364.50 per semester
USC Shrine Structure	On Jefferson Blvd. near the Shrine Auditorium	\$499.50 per semester

Application & Assignment

USC Housing's online application is the fast and convenient way to apply for university housing. Visit housing.usc.edu/portal to get started.

The Importance of Applying Early

Housing assignments for incoming freshmen are made on a first-come, first-served basis. After class standing, the single most important factor in determining where you will be assigned is the date we receive your application. The earlier you apply, the greater the likelihood you will receive one of your building, room-type or program preferences. This is particularly true for freshman buildings in high demand. Only admitted students may apply, and it's a good idea to apply as soon as you are admitted and receive your login information.

Please note: USC Housing expects to receive applications from newly admitted students for the 2019-2020 academic year as early as February 2019. Most incoming freshmen apply by May 1.

Portal Login

After you are admitted to USC, you will receive an email from USC Housing that will include your login information. You will not be able to apply for housing until you receive this email. For students admitted prior to February 1, login information will be emailed late in January. For all other students, it will be emailed within a week of admission.

To log in, use your 10-digit USC ID number (no spaces or dashes) and the password emailed to you. Demographic information including name, gender, date of birth and permanent address will already be uploaded to our system. Please visit your Profile to ensure this is correct and to enter any additional details, such as your emergency contact information.

TIP

Check the USC Housing website at housing.usc.edu for the most up-to-date housing and application information.

May 1, 2019

Freshman Housing Guarantee Deadline

Incoming freshmen whose housing applications are received in our office by the May 1 deadline:

- Are guaranteed a space in USC Housing;
- Are eligible to be considered for a special interest community; and
- May participate in the online roommate-matching process.

Meeting the May 1 deadline for guaranteed freshman housing does not necessarily mean you will be assigned to one of your top choices, so you are strongly advised to apply as soon as you are admitted.



Applying for Housing

Freshmen may apply for housing once they have been admitted to the university and have been issued a 10-digit USC student identification number. You may submit a housing application before sending your Enrollment Commitment Deposit form.

To apply, visit our online portal, click on Application and select the term for which you are applying (Academic Year 2019-2020, for those starting in August 2019; or Spring 2020, for those starting in January 2020).

Profile

After logging in, you can click on the Profile option to complete a profile — information we need to make your housing assignment. Your personal details and any special needs information will remain private. You can change your profile at any time by clicking on Profile on the application web page.

Application

Begin Application

To start your application, click on the Apply button at the bottom of the page.

Personal & Contact Details

Here you will provide us with information we need to determine what housing is appropriate for you, such as your class standing, marital status, and any physical or medical needs we should consider when making your assignment. (You must register with Disability Services if you need special housing. Please see page 5.) In addition, you will be asked to provide emergency contact information.

You will also be asked to create a screen name that your potential roommates will see.

Profile Questions

In this section you will answer a series of questions about your personal living preferences, giving you the opportunity to participate in our roommate-matching process. (See “Living With Others,” page 23.)

Application Category

Please select your category. Newly admitted students should choose “New to USC.”

List Housing Preferences

You must list five housing preferences in order of interest. Please review the building descriptions in this brochure or on our website before entering your preferences.

Please select buildings only for freshmen. This step will remain open to allow you to make changes to your preferences up until assignments begin in mid-May.

Special Interest Housing

You may indicate a special interest program for which you would like to be considered. If you are requesting a special interest program, be certain to list the corresponding building as your first housing preference. If you are interested in Gender Inclusive Housing, select that program here.

Supplemental Application

Some special interest programs, as well as Gender Inclusive Housing, require a supplemental application, which may be completed here. For more information on which programs require supplemental applications, please see page 22.

Pay Application Fee

USC Housing cannot process your application before receiving your \$55 nonrefundable application fee. (This fee cannot be waived.)

Our website accepts Visa, Mastercard, American Express or Discover Card. When your payment has been accepted, we will email you confirmation.

Although you have the option to select a roommate, you are eligible for assignment once you pay the application fee.

At this point your application is complete.

When you have been assigned, we will notify you by email and direct you back to the portal to complete the steps listed in the Contracts section on the next page.

Roommate Selection (Optional)

If you would like to request a specific roommate, you can add that person to your application by entering his or her screen name and/or 10-digit USC ID number. For your requests to be considered, they must be mutual and the housing preferences, including any special interest programs, for each roommate must be exactly the same. Roommate requests cannot be guaranteed.

If you do not have a specific person in mind, you can conduct an online search for potential roommates and be presented with possible matches based on the information provided

in your Profile. You will be able to contact potential roommates, and update your application to request them, up until the time assignments are made. (See “Living With Others,” page 23.)

Rooms

Once you have been assigned a housing space, you will be notified by email. You can then log in to the Application portal on the Housing website to review your assignment.

Assignments

We can offer housing assignments only to students who have submitted their USC Enrollment Commitment Deposit form and the \$300 enrollment deposit, or approved waiver, to the Office of Admission.

The USC Housing Services Office makes assignments based on space availability and the following criteria:

- The date your application is received by USC Housing Services; and
- Available spaces in the buildings or programs you have requested and for which you are eligible.

Your assignment will be as close to your requests as possible, based on availability and eligibility; however, there is a possibility that it may not match any of your building preferences. (Please note that your room or apartment number is not guaranteed and is subject to change without notice.)

Freshmen (as defined on page 3) whose housing applications are received by USC Housing on or before May 1 are guaranteed housing. This is not a guarantee of a particular type of assignment or a specific building. Early receipt of your housing application increases your chances of being assigned to one of your building or program preferences; it does not guarantee it.

Housing Assignments

Contracts

After reviewing your assignment, you will need to accept and confirm your contract to finalize your housing.

Confirmation Payment

You may submit your \$800 confirmation payment electronically by Visa, Mastercard, American Express or Discover Card. Half this fee will be credited to your student account in the fall semester and the other half in the spring semester.

Contract & Finish

To confirm your assignment, first read through the Living Agreement. You must then click on the I Agree button to accept the terms and finalize your contract; if you fail to do so, your assignment will be cancelled. Clicking on the I Agree button is the electronic equivalent of signing a contract, and by doing so you are agreeing to be legally bound by the terms of the Living Agreement.

Important: If you do not confirm your contract and make the confirmation payment by the due date indicated, your assignment will be cancelled and given to another applicant.

Meal Plans

This page will show the default, mandatory meal plan for your assignment. You can add or change a meal plan at the USCard website at mycard.usc.edu.

Once you have accepted the contract, you will see a confirmation page, summarizing the basic details of your housing assignment, including your current roommate(s). Please print a copy for your personal records.

Reassignments

If you would like to change your assignment after receiving your contract, you can request a reassignment. To be eligible, you need to have confirmed your contract and made the \$800 confirmation payment prior to submitting your request. Reassignments are processed in two ways: by reassignment list and over the counter.

Reassignment List (Prior to Move-In)

To request an assignment change prior to move-in, please read the reassignment information on our website and submit

the Reassignment Request form that can be found there. Requests are placed on a reassignment list in the order received, and processed based on eligibility, gender and space availability. We make every effort to complete requests, but reassignment is not guaranteed. If we are able to fulfill your request, you will be emailed confirmation that you have been reassigned. This will be your new housing assignment; your previous assignment will be cancelled and offered to another student.

Reassignments are processed from late May to mid-July. On July 19, the Housing Services Office will begin cancelling all unfulfilled requests. If your request is not fulfilled, you should move into your contracted housing assignment on August 21. No new requests will be accepted until the reassignment process re-opens in September.

Over the Counter (After Move-In)

There is no reassignment list during the academic year. Beginning Wednesday, September 11, reassignments may be requested over the counter at any CSC or at the main Housing Office. If a space that meets your housing needs and eligibility becomes available, you can be reassigned on the spot. Reassignments during the academic year are halted from mid-November to mid-January to facilitate the assignment of students arriving spring semester.

Cancellations

If you decide to cancel your application prior to being assigned, or to cancel your housing assignment prior to confirming your contract, print and complete the Cancellation Request form on our website and send it to USC Housing Services. The application or assignment will be cancelled; the \$55 application fee will not be refunded.

You are responsible for the terms of the contract once it has been confirmed; however, you may still submit a Cancellation Request to be released from your contract.

- If your cancellation is granted by June 7, you will receive a full refund of the contract confirmation payment.

- If your cancellation is granted after June 7, you will not be eligible for a refund of the \$800 contract confirmation payment, even if you decide to withdraw from the university.
- If your cancellation request is not granted, your contract will be in force and you will be held to its provisions.

You may request in writing to reactivate your application at any time during the same academic year without paying an additional fee. For assignment purposes, the date of reactivation will be your new application date.

Contract Dates

Specific start and end dates are associated with university housing contracts. Once confirmed, the contract is in force for that time period. All housing contracts run for the full academic year. Monthly and semester-length contracts are not available.

University Park & North University Park Housing

All housing contracts for these spaces begin on Wednesday, August 21, 2019, and end on Wednesday, May 13, 2020. However, university residence halls and suites are closed for safety and security reasons during the winter break, from December 18, 2019, at 5:00 p.m. (the last day of fall semester finals) to January 9, 2020, at 8:30 a.m. You do not need to move out your belongings, but you will not have access to your room. Be sure to take everything you need with you, and plan to stay elsewhere during that period. Residence halls remain open during Thanksgiving and spring breaks. Check with your Customer Service Center for details. Apartment buildings remain open for the full academic year and may be continuously occupied by residents through the winter and spring breaks.



Requests for Early Arrival

Some departments and programs schedule activities before the official Move-In date of August 21, 2019. To the extent possible, we want to accommodate residents who wish to check in to their housing assignments early for these activities. Early arrival requests must be received in writing from the department or academic program with which you are affiliated.

Residents may request early arrival on an individual basis. Because we must also plan for summer school student departures, conferences and other university summer programs, individual requests may not be honored. Requests should be submitted by August 1 to the email address of the Customer Service Center for your housing assignment (see p. 37). Requests may not be made for arrival earlier than August 18.

Customer Service Centers grant final approval of an early-arrival request, and will do so only if there is sufficient time to clean and prepare the room. You will receive an email response letting you know if your

request can be accommodated. Incoming residents must call their Customer Service Center to verify early move-in approval before arriving at USC.

If the request is approved, you will be charged \$75 for each night stayed prior to the first day of your housing contract. Residents who arrive without approval may be turned away. Those who can be accommodated will be charged a \$200 per night fee.

Applying by Mail-In Application

If you would prefer to submit a written application, please visit our website to download an application form. Complete the form and mail it, along with the mandatory \$55 nonrefundable application fee, to USC Housing Services, 620 McCarthy Way, PSX 137, Los Angeles, CA 90089-1332. (Please note that our roommate-matching process is available only to students who apply online.)

The USC Housing Office will send you a receipt card to let you know that your application was received. Your application

date will be the date your application is received in our office — not the postmark date. Once we have made your housing assignment, we will notify you by email.

How to Apply for Residential Colleges & Special Interest Communities

If you would like to live in special interest housing, indicate the desired program and its corresponding building in your housing preferences. To be considered for your special interest preference, your application and \$55 application fee must be received by May 1. Note: Some programs require supplemental applications. For more information, see pages 8-22.

Summer Housing

There is a separate application and assignment process for summer housing. More information about summer housing will be available in late March 2019. Please contact the USC Housing Services Office or your CSC about summer housing options and application information.

Application & Assignments Timeline

Late January	May 1	Mid-May	Late May	Early June
First Housing Applications Mailed with Admission Letters	Application Deadlines for: Guaranteed Freshman Housing, Freshman Roommate-Matching Eligibility & Special Interest Communities	Email Notification of First Round of Freshman Assignments	Email Reassignment Notifications Begin	Email Notification of Second Round of Freshman Assignments
June 7	July 19	Early August	August 21 MOVE-IN DAY!	
Last Day for New Students to Cancel with \$800 Refund	Reassignment List Ends	Move-in Information Mailed		



Housing for Spring 2020

Freshman students admitted for the spring semester can submit a housing application beginning July 1, 2019. The housing information and procedures presented throughout this brochure apply to applicants for spring housing, except for the important differences noted below.

Availability

All freshmen applying for spring housing will be offered assignments. However, we are unable to ensure they will be offered a space in freshman buildings on campus. Spring housing assignments are based on: (1) the number of students admitted to USC for spring semester; and (2) the number of students who leave university housing during fall semester. Freshman housing is usually filled to capacity at the beginning of fall semester; only spaces that become vacant can be offered to freshmen admitted to spring semester.

The availability of specific housing types is difficult to predict, and it is often not possible to place applicants in their top preferences or with requested roommates. *As space allows, spring admits will be assigned to freshman spaces; however, to be offered university housing most freshmen arriving spring semester will be placed in upperclassman undergraduate buildings in North University Park.* More information about our facilities for upperclassmen, along with a complete map of all university housing locations, can be found at housing.usc.edu.

Application & Assignment

The application for spring 2020 housing will not be available until July 1, 2019. Your application login information will be emailed to you in late June. In the past, the majority of spring applications have been received on July 1. Due to high demand and the uncertain supply of housing spaces, you should apply early for the best chance of receiving a housing assignment. To be considered for spring housing, you must select the Spring 2020 option when applying.

Assignments for Spring 2020 will begin in mid- to late November 2019, and will be based on application date, gender and availability. Students will be notified of their assignments by email and directed to the Housing Application portal on the USC Housing website to confirm their contracts. Students assigned for the spring will not be eligible for reassignment until over-the-counter reassignment begins in mid-January (see page 34).

MOVE-IN DAY FOR SPRING RESIDENTS IS JANUARY 9, 2020.

Directory

USC Housing Services

620 McCarthy Way
Los Angeles, CA 90089-1332
Tel: (800) 872-4632 or
(213) 740-2546
Fax: (213) 740-8488
Email: housing@usc.edu
Website: housing.usc.edu

Office for Residential Education

3601 Trousdale Parkway
Suite 200
Los Angeles, CA 90089-4892
Tel: (213) 740-2080
Fax: (213) 740-9781
Website: resed.usc.edu

Department of Public Safety

Emergency
Tel: (213) 740-4321

Non-emergency
Tel: (213) 740-6000

USC Transportation Services

Tel: (213) 740-3575
Website: transnet.usc.edu

USCard & Meal Plans

Tel: (213) 740-8709
Website: mycard.usc.edu

USC Bookstore

Tel: (213) 740-0066
Website:
www.uscbookstore.com

USC Hospitality

Tel: (213) 740-6285
Website: hospitality.usc.edu



Customer Service Centers (CSC)

University Park Campus Centers (Los Angeles, California, 90089)

Parkside Arts & Humanities Residential College (CSC)

Tel: (213) 740-8860
Fax: (213) 740-4196
Email: mailprb@usc.edu

Parkside Arts & Humanities Residential College

920 West 37th Place

West Residential College (CSC)

Tel: (213) 740-2651
Fax: (213) 740-3368
Email: mailft@usc.edu

Fluor Tower

1027 West 34th Street

Parkside International Residential College (CSC)

Tel: (213) 740-1941
Fax: (213) 740-3454
Email: mailpks@usc.edu

Parkside International Residential College

3771 South McClintock Avenue

McCarthy Honors College (CSC)

McCarthy Honors College
3096 South McClintock Avenue
Tel: (213) 764-7904
Email: mailuvf@usc.edu

New North Residential College (CSC)

Tel: (213) 740-1492
Fax: (213) 740-3381
Email: mailevk@usc.edu

New North Residential College

635 McCarthy Way

Birnkrant Residential College

642 West 34th Street

South Residential College(CSC)

Tel: (213) 740-3626
Fax: (213) 740-6234
Email: mailptd@usc.edu

Marks Hall

631 Childs Way

Marks Tower

612 Hellman Way

Pardee Tower

614 Hellman Way

Trojan Hall

615 Childs Way



Office of Admission

University of Southern California
Los Angeles, California 90089-0911
www.usc.edu